

## Wilo-Star-Z NOVA

- |           |   |           |                                      |
|-----------|---|-----------|--------------------------------------|
| <b>GB</b> | Installation and operating instructions       | <b>GR</b> | Οδηγίες εγκατάστασης και λειτουργίας |
| <b>F</b>  | Notice de montage et de mise en service       | <b>TR</b> | Montaj ve kullanma kılavuzu          |
| <b>E</b>  | Instrucciones de instalación y funcionamiento | <b>H</b>  | Beépítési és üzemeltetési utasítás   |
| <b>I</b>  | Istruzioni di montaggio, uso e manutenzione   | <b>PL</b> | Instrukcja montażu i obsługi         |

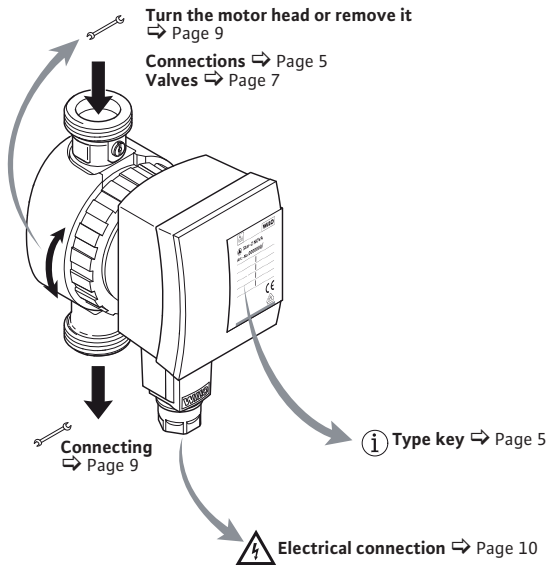

<b>GB</b>	Installation and operating instructions	2
<b>F</b>	Notice de montage et de mise en service	14
<b>E</b>	Instrucciones de instalación y funcionamiento	26
<b>I</b>	Istruzioni di montaggio, uso e manutenzione	38
<b>GR</b>	Οδηγίες εγκατάστασης και λειτουργίας	50
<b>TR</b>	Montaj ve kullanma kılavuzu	62
<b>H</b>	Beépítési és üzemeltetési utasítás	74
<b>PL</b>	Instrukcja montażu i obsługi	86



⚠ Safety ⇨ Page 3

i Principle of operation ⇨ Page 7

🔧 Installation ⇨ Page 8

{ Faults ⇨ Page 13

## 2 Safety

### *About these instructions*

- Read through these instructions completely before installation. Non-observance of these instructions can result in injury to persons and damage to the pump/unit.
- Once installation work is complete, pass the instructions on to the end user.
- Keep the instructions near the pump. They can be used as a reference if problems occur later.
- We accept no liability for damages resulting from failure to follow these instructions.

### *Safety information*

Important safety information is indicated as follows:



**Danger:** Indicates a danger to life due to electrical current.



**Warning:** Indicates a possible danger to life or injury.



**Caution:** Indicates possible risks to the pump or other items.



**Note:** Highlights tips and information.

*Qualification* The pump may only be installed by qualified personnel. This product may not be commissioned or operated by persons with insufficient accountability (including children) or who do not possess the relevant specialist knowledge. Exceptions are only permitted on appropriate instruction from safety-responsible persons. The electrical connection may only be established by a qualified electrician.

*Regulations* The current versions of the following regulations must be observed when installing the equipment:

- Accident prevention regulations
- DVGW worksheet W551 (in Germany)
- VDE 0370/Part 1
- Other local regulations (e.g. IEC, VDE, etc.)

*Conversion, spare parts* The pump must not be technically modified or converted. It is not permitted to open the pump motor by removing the plastic lid. Only use original spare parts.

*Transport* Unpack and check the pump and all accessories upon receipt. Report any damage sustained in transit immediately.  
Dispatch the pump in the original packing only.

*Electrical current* There is a danger of an electric shock when working with electrical current. Therefore:

- Switch off the power before beginning work on the pump and make sure that it cannot be switched on again accidentally.
- Do not kink or nip the power cable or allow it to come into contact with heat sources.
- The pump is protected against drips in accordance with protection class IP 42. Protect the pump against water spray. Do not immerse in water or other fluids.

### 3.1 Type key

Star-Z	Series: Standard secondary hot water circulation pump, glandless pump
NOVA	Type designation A = with check valves C = with check valves and ready for connection with plug clock timer

### 3.2 Connections

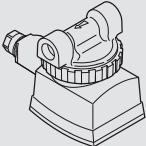
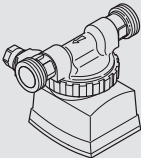
	<b>Star-Z NOVA</b> Screwed connection: 15 (Rp 1/2")
	<b>Star-Z NOVA A and Star-Z NOVA C</b> Screwed connection: 15 (Rp 1/2") and check valves

## 3.3 Data

Star-Z NOVA, Star-Z NOVA A, Star-Z NOVA C	
Mains voltage	1 ~ 230 V / 50 Hz
Protection class	42
Nominal diameter of connecting pipes	R 1/2
Installation length	84 mm (Type A: 138 mm)
Maximum permissible operating pressure	10 bar
Permitted fluid temperature range	2 °C to 65 °C, in short-term operation up to 2 hours 70 °C
Max. ambient temperature	+ 40 °C
Max. permitted total hardness in secondary hot water circulation systems	20 °dH

See name plate or Wilo catalogue for further information.

## 3.4 Scope of delivery

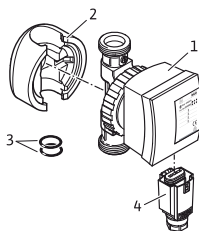

- 1 Pump
- 2 Thermal insulation shell
- 3 Sealing rings
- 4 Wilo-Connector
- 5 Installation and operating instructions (not shown)



#### 4.1 Application

The pump is intended for pumping potable or process water in a circulation system.

#### 4.2 Functions

##### Valves

The Star-Z NOVA A and Star-Z NOVA C versions are equipped with a non-return valve (1) on the pressure side and with a stop valve (2) on the suction side.

When exchanging the motor head (3), it is sufficient to cut the power by unplugging the connector (5) and to close the stop valve at the rotating slot (4). The motor head can then be simply unscrewed → Page 9.

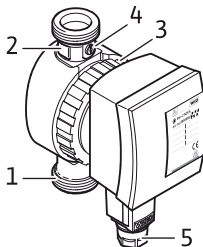

## 5.1 Mechanical installation



**Danger:** Before starting work, make sure that the pump has been disconnected from the power supply.

Installation site

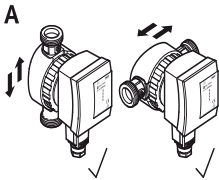

Provide a weatherproof, frost-free, dust-free and well-ventilated room for the installation. Choose an installation site that is easily accessible.



**Caution:** Dirt can cause the pump to fail. Flush the pipe system before installation.



**Note:** In the case of the Star-Z NOVA A and Star-Z NOVA C versions, the stop valve and non-return valve are pre-installed. In the case of the Star-Z NOVA version, these valves have to be installed additionally.

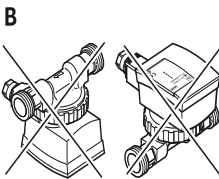

1. Prepare the installation site so that the pump can be installed without being exposed to mechanical stresses.
2. Choose the right installation position – only as shown in (Fig. A).  
The arrow on the back of the housing indicates the direction of flow.

Turn the motor head or remove it

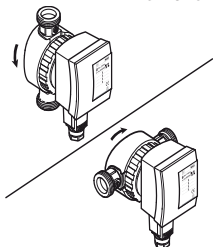

Open the stop valve

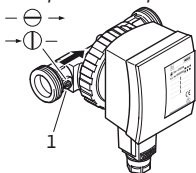

Connecting

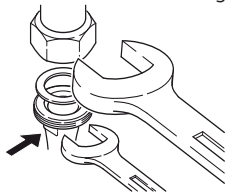

3. Release the union nut – unscrew it completely if necessary.



**Caution:** Do not damage the housing seal. Replace damaged seals.

4. Turn the motor head so that the Wilo-Connector points downwards.



**Caution:** If the position is wrong, water can penetrate and destroy the pump.

5. Tighten the union nut again.
6. Turn slot (1) with a screwdriver so that it is parallel to the direction of flow (only in the case of the Star-Z NOVA A, and Star-Z NOVA C versions).



**Note:** To close, turn the slot so that it is across the direction of flow.

7. Fit the thermal insulation shell.



**Caution:** The plastic parts of the motor may not be heat-insulated in order to protect the pump from overheating.

8. Connect the pipework.



**Caution:** For the versions with stop and non-return valves, these are already pre-installed and sealed with a tightening torque of 15 Nm (hand-tight). Screwing with excessive tightening torque destroys the valve screw connection and the O ring. When installing the valve, use a fixed spanner to prevent twisting.

## 5.2 Electrical connection



**Danger:** Only a qualified electrician is allowed to work on the electrical connection. Before establishing the connection, make sure that the connecting cable is dead.

Establish the electrical connection as follows:

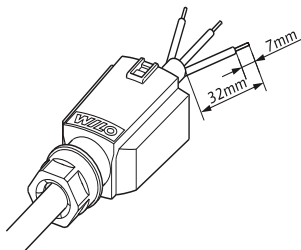

Fig. 1

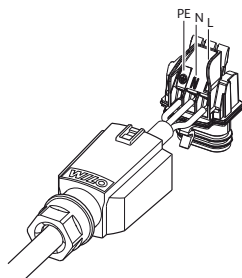

Fig. 2

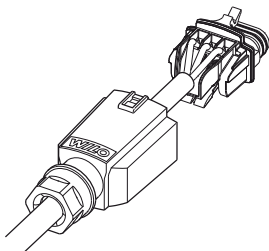

Fig. 3

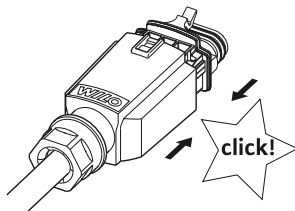

Fig. 4

Open the WILO- Connector as follows:

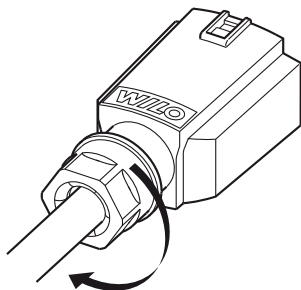
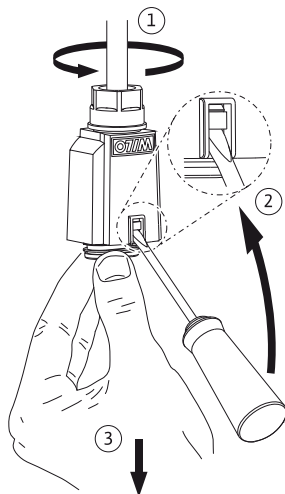

Fig. 5



### 5.3 Filling and bleeding

1. Fill the system.
2. The pump rotor space bleeds automatically after a short time in operation. This may cause noises. If necessary, switch off and on repeatedly to accelerate the bleeding. Dry running for short periods will not harm the pump.

*Cleaning* Clean the outside of the pump with a slightly damp cloth only. Do not use detergents.

*Replacing the motor head*



**Warning:** When removing the motor head or pump, hot fluid may spurt out under high pressure. Allow the pump to cool down beforehand.

Close the stop valves before removing the pump  
⇒ Page 9.



**Note:** When the motor is removed and running, noises and a change in rotation may occur. This is normal for this situation.

Faultless operation can only be guaranteed when the pump is operated in fluid.

Replacing the motor head ⇒ Page 9.

Order the service motor from a specialist retailer.

Faults	Causes	Remedies
Pump does not start.	Interruption in the power supply, short-circuit or defective fuses.	Have the power supply checked by a qualified electrician.
	Time switching function has switched off automatically (Star-Z NOVA C version only).	Check the plug clock timer setting.
	Motor is blocked, e.g. by deposits from the water mains.	Have the pump removed by a qualified technician ⇒ Page 9.
Pump is making noises.	Motor scraping, e.g. through deposits from the water mains	Check that the impeller can move by turning it and rinse out the dirt that has accumulated.
	Running dry, too little water.	Check the check valves, they must be fully open.
	Air in the pump.	Switch the pump on/off 5 times for 30 s in each case.



**Note:** If you cannot remedy the fault, contact a specialist retailer.

**D** **EG – Konformitätserklärung**  
**GB** **EC – Declaration of conformity**  
**F** **Déclaration de conformité CE**

Hiermit erklären wir, dass die Bauarten der Baureihe : **Star Z Nova**  
*Herewith, we declare that this product:*  
*Par le présent, nous déclarons que cet agrégat :*

in der gelieferten Ausführung folgenden einschlägigen Bestimmungen entspricht:  
*in its delivered state complies with the following relevant provisions:*  
*est conforme aux dispositions suivants dont il relève:*

**Elektromagnetische Verträglichkeit – Richtlinie** **2004 / 108 / EG**  
**Electromagnetic compatibility – directive**  
**Compatibilité électromagnétique – directive**

**Niederspannungsrichtlinie** **2006 / 95 / EG**  
**Low voltage directive**  
**Directive basse-tension**

und entsprechender nationaler Gesetzgebung.  
*and with the relevant national legislation.*  
*et aux législations nationales les transposant.*

Angewendete harmonisierte Normen, insbesondere: **EN 60335-2-51**  
*Applied harmonized standards, in particular:* **EN 61000-3-2**  
*Normes harmonisées, notamment:* **EN 61000-3-3**  
**EN 55014-1&2**

Bei einer mit uns nicht abgestimmten technischen Änderung der oben genannten Bauarten, verliert diese Erklärung ihre Gültigkeit.  
If the above mentioned series are technically modified without our approval, this declaration shall no longer be applicable.  
Si les gammes mentionnées ci-dessus sont modifiées sans notre approbation, cette déclaration perdra sa validité.



Dortmund, 15.04.2009

  
Oliver Breuing  
Quality Manager



WILO SE  
Nortkirchenstraße 100  
44263 Dortmund  
Germany



<p><b>NL EG-verklaring van overeenstemming</b> Hiermede verklaren wij dat dit aggregaat in de geleverde uitvoering voldoet aan de volgende bepalingen:</p> <p>Elektromagnetische compatibiliteit 2004/108/EG EG-laagspanningsrichtlijn 2006/95/EG</p> <p>Gebruikte geharmoniseerde normen, in het bijzonder: <b>1)</b></p>	<p><b>I Dichiarazione di conformità CE</b> Con la presente si dichiara che i presenti prodotti sono conformi alle seguenti disposizioni e direttive rilevanti:</p> <p>Compatibilità elettromagnetica 2004/108/EG Direttiva bassa tensione 2006/95/EG</p> <p>Norme armonizzate applicate, in particolare: <b>1)</b></p>	<p><b>E Declaración de conformidad CE</b> Por la presente declaramos la conformidad del producto en su estado de suministro con las disposiciones pertinentes siguientes:</p> <p>Directiva sobre compatibilidad electromagnética 2004/108/EG Directiva sobre equipos de baja tensión 2006/95/EG</p> <p>Normas armonizadas adoptadas, especialmente: <b>1)</b></p>
<p><b>P Declaração de Conformidade CE</b> Pela presente, declaramos que esta unidade no seu estado original, está conforme os seguintes requisitos:</p> <p>Compatibilidade electromagnética 2004/108/EG Directiva de baixa voltagem 2006/95/EG</p> <p>Normas harmonizadas aplicadas, especialmente: <b>1)</b></p>	<p><b>S CE- försäkrän</b> Härmed förklarar vi att denna maskin i levererat utförande motsvarar följande tillämpliga bestämmelser:</p> <p>EG-Elektromagnetisk kompatibilitet – riktlinje 2004/108/EG EG-Lågspänningsdirektiv 2006/95/EG</p> <p>Tillämpade harmoniserade normer, i synnerhet: <b>1)</b></p>	<p><b>N EU-Overensstemmelseerklæring</b> Vi erklærer hermed at denne enheten i utførelse som levert er i overensstemmelse med følgende relevante bestemmelser:</p> <p>EG-EMV-Elektromagnetisk kompatibilitet 2004/108/EG EG-Lavspenningsdirektiv 2006/95/EG</p> <p>Anvendte harmoniserte standarder, særlig: <b>1)</b></p>
<p><b>FIN CE-standardinmukaisuuslause</b> Ilmoitamme täten, että tämä laite vastaa seuraavia asiaankuuluvia määräyksiä:</p> <p>Sähkömagneettinen soveltuvuus 2004/108/EG Matalajännitte direktiivi: 2006/95/EG</p> <p>Käytetyt yhteensovitettut standardit, erityisesti: <b>1)</b></p>	<p><b>DK EF-overensstemmelseerklæring</b> Vi erklærer hermed, at denne enhed ved levering overholder følgende relevante bestemmelser:</p> <p>Elektromagnetisk kompatibilitet: 2004/108/EG Lavvolts-direktiv 2006/95/EG</p> <p>Anvendte harmoniserede standarder, særligt: <b>1)</b></p>	<p><b>H EK. Azonosság nyilatkozat</b> Ezennel kijelentjük, hogy az berendezés az alábbiaknak megfelel:</p> <p>Elektromágneses zavarás/tűrés: 2004/108/EG Kisfeszültségű berendezések irány-Elve: 2006/95/EG</p> <p>Felhasznált harmonizált szabványok, különösen: <b>1)</b></p>
<p><b>CZ Prohlášení o shodě EU</b> Prohlašujeme tímto, že tento agregát v dodaném provedení odpovídá následujícím příslušným ustanovením:</p> <p>Směrnice EU-EMV 2004/108/EG Směrnice EU-nízké napětí 2006/95/EG</p> <p>Použité harmonizační normy, zejména: <b>1)</b></p>	<p><b>PL Deklaracja Zgodności CE</b> Niniejszym deklarujemy z pełną odpowiedzialnością że dostarczony wyrób jest zgodny z następującymi dokumentami:</p> <p>Odpowiedniość elektromagnetyczna 2004/108/EG Normie niskich napięć 2006/95/EG</p> <p>Wyroby są zgodne ze szczegółowymi normami zharmonizowanymi: <b>1)</b></p>	<p><b>RUS Декларация о соответствии Европейским нормам</b> Настоящим документом заявляем, что данный агрегат в его объеме поставки соответствует следующим нормативным документам:</p> <p>Электромагнитная устойчивость 2004/108/EG Директивы по низковольтному напряжению 2006/95/EG</p> <p>Используемые согласованные стандарты и нормы, в частности: <b>1)</b></p>
<p><b>GR Δήλωση προσαρμογής της Ε.Ε.</b> Δηλώνουμε ότι το προϊόν αυτό σ' αυτή την κατάσταση παράδοσης ικανοποιεί τις ακόλουθες διατάξεις:</p> <p>Ηλεκτρομαγνητική συμβατότητα EG-2004/108/EG Οδηγία χαμηλής τάσης EG-2006/95/EG</p> <p>Εναρμονισμένα χρησιμοποιούμενα πρότυπα, ιδιαίτερα: <b>1)</b></p>	<p><b>TR EC Uygunluk Teyid Belgesi</b> Bu cihazın teslim edildiği şekliyle aşağıdaki standartlara uygun olduğunu teyid ederiz:</p> <p>Elektromanyetik Uyumluluk 2004/108/EG Alçak gerilim direktifi 2006/95/EG</p> <p>Kisim kullanılan standartlar: <b>1)</b></p>	<p><b>1) EN 60335-2-51, EN 61000-3-2, EN 61000-3-3, EN 55014-1&amp;2.</b></p>
<div style="display: flex; justify-content: space-between; align-items: center;"> <div data-bbox="142 1176 312 1284" style="text-align: center;">   <b>Oliver Breuing</b>  Quality Manager </div> <div data-bbox="685 1153 878 1342" style="text-align: center;">   <b>WILO SE</b>  Nortkirchenstraße 100  44263 Dortmund  Germany </div> </div>		

**WILO**

WILO SE  
 Nortkirchenstraße 100  
 44263 Dortmund  
 Germany  
 T +49 231 4102-0  
 F +49 231 4102-7363  
 wilo@wilo.com  
 www.wilo.com

## Wilo – International (Subsidiaries)

### Argentina

WILO SALMSON  
 Argentina S.A.  
 C1295ABI Ciudad Autónoma  
 de Buenos Aires  
 T +54 11 4361 5929  
 info@salmson.com.ar

### Austria

WILO Pumpen  
 Österreich GmbH  
 2351 Wiener Neudorf  
 T +43 507 507-0  
 office@wilo.at

### Azerbaijan

WILO Caspian LLC  
 1014 Baku  
 T +994 12 5962372  
 info@wilo.az

### Belarus

WILO Bel OOO  
 220035 Minsk  
 T +375 17 2535363  
 wilo@wilo.by

### Belgium

WILO SA/NV  
 1083 Ganshoren  
 T +32 2 4823333  
 info@wilo.be

### Bulgaria

WILO Bulgaria Ltd.  
 1125 Sofia  
 T +359 2 9701970  
 info@wilo.bg

### Canada

WILO Canada Inc.  
 Calgary, Alberta T2A 5L4  
 T +1 403 2769456  
 bill.lowe@wilo-na.com

### China

WILO China Ltd.  
 101300 Beijing  
 T +86 10 58041888  
 wilo@wilo.com.cn

### Croatia

WILO Hrvatska d.o.o.  
 10090 Zagreb  
 T +38 51 3430914  
 wilo-hrvatska@wilo.hr

### Czech Republic

WILO Praha s.r.o.  
 25101 Cestlice  
 T +420 234 098711  
 info@wilo.cz

### Denmark

WILO Danmark A/S  
 2690 Karlslunde  
 T +45 70 253312  
 wilo@wilo.dk

### Estonia

WILO Eesti OÜ  
 12618 Tallinn  
 T +372 6 509780  
 info@wilo.ee

### Finland

WILO Finland OY  
 02330 Espoo  
 T +358 207401540  
 wilo@wilo.fi

### France

WILO S.A.S.  
 78390 Bois d'Arcy  
 T +33 1 30050930  
 info@wilo.fr

### Great Britain

WILO (U.K.) Ltd.  
 DE14 2WJ Burton-  
 upon-Trent  
 T +44 1283 523000  
 sales@wilo.co.uk

### Greece

WILO Hellas AG  
 14569 Anixi (Attika)  
 T +302 10 6248300  
 wilo.info@wilo.gr

### Hungary

WILO Magyarországi Kft  
 2045 Torökbalint  
 (Budapest)  
 T +36 23 889500  
 wilo@wilo.hu

### India

WILO India Mather and  
 Platt Pumps Ltd.  
 Pune 411019  
 T +91 20 27442100  
 service@  
 pun.matherplatt.co.in

### Indonesia

WILO Pumps Indonesia  
 Jakarta Selatan 12140  
 T +62 21 7247676  
 citrawilo@cbtn.net.id

### Ireland

WILO Engineering Ltd.  
 Limerick  
 T +353 61 227566  
 sales@wilo.ie

### Italy

WILO Italia s.r.l.  
 20068 Peschiera Borromeo  
 (Milano)  
 T +39 25538351  
 wilo.italia@wilo.it

### Kazakhstan

WILO Central Asia  
 050002 Almaty  
 T +7 727 2785961  
 info@wilo.kz

### Korea

WILO Pumps Ltd.  
 621-807 Gimhae  
 Gyeongnam  
 T +82 55 3405890  
 wilo@wilo.co.kr

### Latvia

WILO Baltic SIA  
 1019 Riga  
 T +371 7 145229  
 mail@wilo.lv

### Lebanon

WILO SALMSON  
 Lebanon  
 12022030 El Metn  
 T +961 4 722280  
 wsl@cyberia.net.lb

### Lithuania

WILO Lietuva UAB  
 03202 Vilnius  
 T +370 5 2136495  
 mail@wilo.lt

### The Netherlands

WILO Nederland b.v.  
 1551 NA Westzaan  
 T +31 88 9456 000  
 info@wilo.nl

### Norway

WILO Norge AS  
 0975 Oslo  
 T +47 22 804570  
 wilo@wilo.no

### Poland

WILO Polska Sp. z o.o.  
 05-090 Raszyn  
 T +48 22 7026161  
 wilo@wilo.pl

### Portugal

Bombas Wilo-Salmson  
 Portugal Lda.  
 4050-040 Porto  
 T +351 22 2080350  
 bombas@wilo.pt

### Romania

WILO Romania s.r.l.  
 077040 Com. Chiajna Jud.  
 Ilfov  
 T +40 21 3170164  
 wilo@wilo.ro

### Russia

WILO Rus ooo  
 123592 Moscow  
 T +7 495 7810690  
 wilo@wilo.ru

### Saudi Arabia

WILO ME – Riyadh  
 Riyadh 11465  
 T +966 1 4624430  
 wshoula@watanaiand.com

### Serbia and Montenegro

WILO Beograd d.o.o.  
 11000 Beograd  
 T +381 11 2851278  
 office@wilo.co.yu

### Slovakia

WILO Slovakia s.r.o.  
 83106 Bratislava  
 T +421 2 33014511  
 wilo@wilo.sk

### Slovenia

WILO Adriatic d.o.o.  
 1000 Ljubljana  
 T +386 1 5838130  
 wilo.adriatic@wilo.si

### South Africa

Salmson South Africa  
 1610 Edenvale  
 T +27 11 6082780  
 errol.comelius@  
 salmson.co.za

### Spain

WILO Ibérica S.A.  
 28806 Alcalá de Henares  
 (Madrid)  
 T +34 91 8797100  
 wilo.iberica@wilo.es

### Sweden

WILO Sverige AB  
 35246 Växjö  
 T +46 470 727600  
 wilo@wilo.se

### Switzerland

EMB Pumpen AG  
 4310 Rheinfelden  
 T +41 61 83680-20  
 info@emb-pumpen.ch

### Taiwan

WILO-EMU Taiwan Co. Ltd.  
 110 Taipei  
 T +886 227 391655  
 nelson.wu@  
 wiloemutaiwan.com.tw

### Turkey

WILO Pompa Sistemleri  
 San. ve Tic. A.Ş.  
 34888 Istanbul  
 T +90 216 6610211  
 wilo@wilo.com.tr

### Ukraine

WILO Ukraina t.o.w.  
 01033 Kiev  
 T +38 044 2011870  
 wilo@wilo.ua

### United Arab Emirates

WILO Middle East FZE  
 Jebel Ali Free Zone – South  
 – Dubai  
 T +971 4 880 91 77  
 info@wilo.ae

### USA

WILO USA LLC  
 1290 N 25<sup>th</sup> Ave  
 Melrose Park, Illinois 60160  
 T +1 866 945 6872  
 info@wilo-usa.com

### Vietnam

WILO Vietnam Co Ltd.  
 Ho Chi Minh City, Vietnam  
 T +84 8 38109975  
 nkminh@wilo.vn

## Wilo – International (Representation offices)

### Algeria

Bad Ezzouar, Dar El Beida  
 T +213 21 247979

### Armenia

0001 Yerevan  
 T +374 10 544336

### Bosnia and Herzegovina

71000 Sarajevo  
 T +387 33 714510

### Georgia

0179 Tbilisi  
 T +995 32 306375

### Macedonia

1000 Skopje  
 T +389 2 3122058

### Mexico

07300 Mexico  
 T +52 55 55863209

### Moldova

2012 Chisinau  
 T +373 22 223501

### Rep. Mongolia

Ulaanbaatar  
 T +976 11 314843

### Tajikistan

734025 Dushanbe  
 T +992 37 2312354

### Turkmenistan

744000 Ashgabad  
 T +993 12 345838

### Uzbekistan

100015 Tashkent  
 T +998 71 1206774

March 2011



WILO SE  
Nortkirchenstraße 100  
44263 Dortmund  
Germany  
T 0231 4102-0  
F 0231 4102-7363  
wilo@wilo.com  
www.wilo.de

## Wilo-Vertriebsbüros in Deutschland

### Nord

WILO SE  
Vertriebsbüro Hamburg  
Beim Strohhaue 27  
20097 Hamburg  
T 040 5559490  
F 040 5559494  
hamburg.anfragen@wilo.com

### Ost

WILO SE  
Vertriebsbüro Dresden  
Frankenring 8  
01723 Kesselsdorf  
T 035204 7050  
F 035204 70570  
dresden.anfragen@wilo.com

### Süd-West

WILO SE  
Vertriebsbüro Stuttgart  
Hertichstraße 10  
71229 Leonberg  
T 07152 94710  
F 07152 947141  
stuttgart.anfragen@wilo.com

### West

WILO SE  
Vertriebsbüro Düsseldorf  
Westring 19  
40721 Hilden  
T 02103 90920  
F 02103 909215  
duesseldorf.anfragen@wilo.com

### Nord-Ost

WILO SE  
Vertriebsbüro Berlin  
Juliusstraße 52-53  
12051 Berlin-Neukölln  
T 030 6289370  
F 030 62893770  
berlin.anfragen@wilo.com

### Süd-Ost

WILO SE  
Vertriebsbüro München  
Adams-Lehmann-Straße 44  
80797 München  
T 089 4200090  
F 089 42000944  
muenchen.anfragen@wilo.com

### Mitte

WILO SE  
Vertriebsbüro Frankfurt  
An den drei Hasen 31  
61440 Oberursel/Ts.  
T 06171 70460  
F 06171 704665  
frankfurt.anfragen@wilo.com

### Kompetenz-Team Gebäudetechnik

WILO SE  
Nortkirchenstraße 100  
44263 Dortmund  
T 0231 4102-7516  
T 01805 R-U-F-W-I-L-O\*  
7-8-3-9-4-5-6  
F 0231 4102-7666

### Kompetenz-Team Kommune Bau + Bergbau

WILO SE, Werk Hof  
Heimgartenstraße 1-3  
95030 Hof  
T 09281 974-550  
F 09281 974-551

### Werkskundendienst Gebäudetechnik Kommune Bau + Bergbau Industrie

WILO SE  
Nortkirchenstraße 100  
44263 Dortmund  
T 0231 4102-7900  
T 01805 W-I-L-O-K-D\*  
9-4-5-6-5-3  
F 0231 4102-7126  
kundendienst@wilo.com

### Wilo-International

**Österreich**  
Zentrale Wiener  
Neudorf:  
WILO Pumpen Österreich  
GmbH  
Wilo Straße 1  
A-2351 Wiener Neudorf  
T +43 507 507-0  
F +43 507 507-15  
office@wilo.at  
www.wilo.at

**Schweiz**  
EMB Pumpen AG  
Gerstenweg 7  
CH-4310 Rheinfelden  
T +41 61 83680-20  
F +41 61 83680-21  
info@emb-pumpen.ch  
www.emb-pumpen.ch

Erreichbar Mo-Do 7-18 Uhr, Fr 7-17 Uhr.

- Antworten auf
  - Produkt- und Anwendungsfragen
  - Liefertermine und Lieferzeiten
- Informationen über Ansprechpartner vor Ort
- Versand von Informationsunterlagen

Täglich 7-18 Uhr  
erreichbar  
24 Stunden Technische  
Notfallunterstützung

- Kundendienst-  
Anforderung
- Werksreparaturen
- Ersatzteillfragen
- Inbetriebnahme
- Inspektion
- Technische  
Service-Beratung
- Qualitätsanalyse

Vertriebsbüro Salzburg:  
Gnigler Straße 56  
A-5020 Salzburg  
T +43 507 507-13  
F +43 662 878470  
office.salzburg@wilo.at  
www.wilo.at

Vertriebsbüro  
Oberösterreich:  
Trattnachtalstraße 7  
A-4710 Grieskirchen  
T +43 507 507-26  
F +43 7248 65054  
office.oberoester-  
reich@wilo.at  
www.wilo.at

### Standorte weiterer Tochtergesellschaften

Die Kontaktdaten finden  
Sie unter [www.wilo.com](http://www.wilo.com).

\* 0,14 €/Min. aus dem Festnetz,  
Mobilfunk max. 0,42 €/Min.